

Non-Return Valve

Metal Seated and Resilient Seated
 Face to Face: DIN EN 558-1 Series 48
 Pressure Rating: PN 20
 Material of Construction: Ductile Cast Iron GGG 40/50



DN 50 - DN 200

Catalogue No: 05-2084820

Range of application: Potable water				
Size	Pressure rating	Hydrotest pressure in bar		Admissible working pressure in bar
DN	PN	Body	Seat	up to 70°C
50 - 200	20	30	20	20

In case of order please specify the working conditions

Other working temperatures possible on request

Materials / Equipment	
Catalogue No.	05-2084820
Body	GGG 40/50
Flap	GGG 40/50
Seating in the body	Stainless steel
Seating on the flap	Stainless steel
Shaft sealing	EPDM or NBR
Shaft	Stainless steel 1.4021
Lever	Mild steel
Weight	Cast iron
Bolts and nuts	Stainless steel A2
Corrosion protection	Epoxy powder coated RAL 5015



Size	Face to face length acc. to DIN EN 558-1 Series 48	Dimensions					Weight	Volume
		L	H	H ₁	F	e ₁		
DN	mm	mm	mm	mm	mm	mm	kg	m ³
50	200	130	60	125	155	165	20	0.02
65	240	155	65	190	175	185	32	0.02
80	260	170	75	210	175	200	37	0.03
100	300	200	95	230	195	235	46	0.30
125	350	225	110	270	225	270	61	0.04
150	400	240	120	310	240	300	82	0.06
200	500	280	155	370	290	360	136	0.11

We reserve the right to make technical modifications

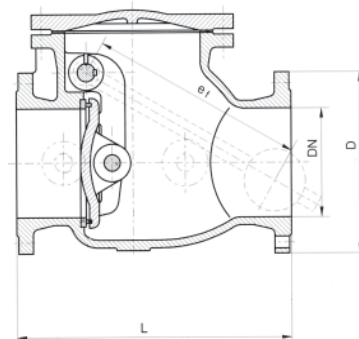
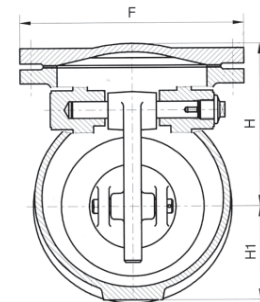

SAUDI VALVES MANUFACTURING

Tel.: +966 3 341 8514 - Fax: +966 3 341 8515

P. O. Box 10137 Jubail Industrial City, 31961 The Kingdom of Saudi Arabia

E-mail: info@saudivalves.com - Internet: www.saudivalves.com

ISO 9001

BUREAU VERITAS
 Certification



N° 215125

20.03.2009