

# Butterfly Valve according to DIN EN 593 with Electric Actuator

Resilient Seated  
 Face to Face: DIN EN 558-1 Series 14  
 Pressure Rating: PN 16  
 Material of Construction: Ductile Cast Iron GGG 40/50



DN 80 - DN 2000

Catalogue No: 06-2031416

Range of application: Potable water				
Size DN	Pressure rating PN	Hydrotest pressure in bar		Admissible working pressure in bar up to 70°C
		Body	Seat	
80 - 2000	16	24	16	16

In case of order please specify the working conditions



Materials / Equipment	
Catalogue No.	06-2031416
Body	GGG 40/50
Disc	GGG 40/50
Seating in the body	Stainless steel
Retaining ring	GGG 40/50
Profile sealing ring	EPDM or NBR
Bearing bushes	Bronze
Shafts	Stainless steel 1.4021
Bearing covers	GGG 40/50
O-rings	EPDM or NBR
Bolts and nuts	Stainless steel A2
Corrosion protection	Epoxy powder coated RAL 5015
Gearbox	Wormgearbox
Electric actuator	Auma or equivalent

Size DN mm	Face to face length acc. to DIN EN 558-1 Series 14 L mm	Flange D mm	Handwheel HR mm	Dimensions						Weight ~ kg	Volume ~ m <sup>3</sup>
				A mm	B mm	h <sub>5</sub> mm	e <sub>1</sub> mm	e <sub>2</sub> mm	e <sub>4</sub> mm		
80	180	200	160	265	249	418	50	115	435	41	0.15
100	190	220	160	265	249	418	50	130	450	47	0.16
125	200	250	160	265	249	418	50	145	470	50	0.17
150	210	285	160	265	249	418	50	165	475	56	0.18
200	230	340	160	265	249	418	63	200	510	76	0.23
250	250	400	160	265	249	443	80	220	567	102	0.24
300	270	455	160	265	249	448	80	270	604	125	0.30
350	290	520	160	265	249	448	100	300	673	182	0.42
400	310	580	160	265	249	562	100	340	708	219	0.47
450	330	640	160	265	249	562	125	380	757	282	0.55
500	350	715	160	265	249	562	125	405	787	337	0.62
600	390	840	160	265	249	567	160	480	857	429	0.89
700	430	910	160	265	249	598	160	535	902	698	1.05
800	470	1025	160	265	249	598	160	585	957	936	1.26
900	510	1125	160	265	249	541	200	650	1037	1,195	1.65
1000	550	1255	160	265	249	663	200	710	1102	1,612	2.00
1100	590	1355	200	282	249	663	200	710	1102	1,945	2.38
1200	630	1485	200	282	254	665	200	840	1237	2,150	2.68
1400	710	1685	315	384	329	885	250	975	1409	2,930	3.10
1500	750	1820	315	384	329	885	250	1030	1476	3,320	3.62
1600	790	1930	315	282	254	885	315	1095	1534	5,168	5.06
1800	870	2130	315	282	254	885	315	1215	1652	6,258	5.83
2000	950	2345	315	282	254	1015	315	1345	1768	8,296	7.55

We reserve the right to make technical modifications

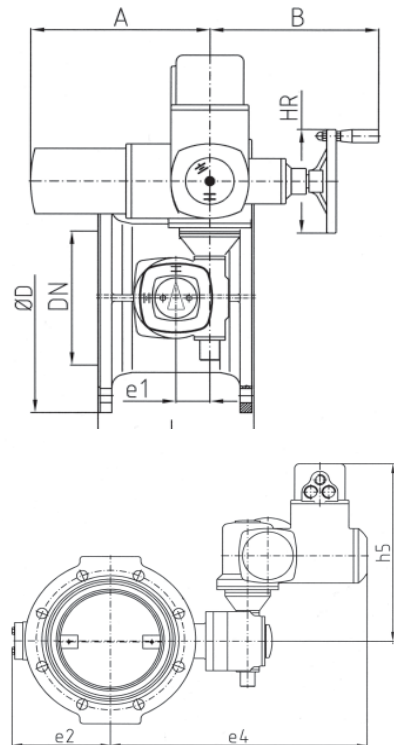

## SAUDI VALVES MANUFACTURING

Tel.: +966 3 341 8514 - Fax: +966 3 341 8515  
 P. O. Box 10137 Jubail Industrial City, 31961 The Kingdom of Saudi Arabia  
 E-mail: [info@saudivalves.com](mailto:info@saudivalves.com) - Internet: [www.saudivalves.com](http://www.saudivalves.com)



N° 215125

20.03.2009